

NFC-LOC

FirstCommand Local Operator Console



Emergency Voice Evacuation

General

Notifier's First Command NFC-LOC is an optional Local Operator Console that is compatible with the NFC-50/100(E) Emergency Voice Evacuation Panel for fire protection applications and mass notification. It is part of a family of external remote consoles that allows for extending the NFC-50/100(E) display and control to remote locations within a building. It consists of a complete operator interface that is identical to the NFC-50/100 main console as well as a built-in microphone with a push-to-talk feature for ALL CALL paging. It is housed in a cabinet with a keyed to prevent unauthorized access. The local operator console requires an external data bus connection, an external audio riser connection, and an external operator interface power connection (24 Volts DC) from the NFC-50/100 main console.

TYPICAL APPLICATIONS

- Schools
- Nursing Homes
- Factories
- Theaters
- Military facilities
- Restaurants
- Auditoriums
- Places of Worship
- Office Buildings

Features

- Provides messaging status and control of the NFC-50/100(E) primary operator console
- Complete operator interface that is identical to the NFC-50/100(E) that includes a built-in microphone for ALL CALL paging
- UL 864 (Emergency Voice Evacuation for Fire) listed
- Certified for seismic applications
- A maximum of eight NFC-LOCs can be connected to an NFC-50/100(E) primary operating console
- Built-in microphone with push-to-talk feature that can be used for ALL CALL paging
- Fourteen programmable message buttons that can be used to activate all speaker circuits remotely
- Sturdy cabinet design with a keyed lock to prevent unauthorized access. Optional thumb lock available
- Simple and straightforward user interface

Electrical Specifications

PRIMARY POWER REQUIREMENTS:

Voltage 24VDC non-resettable power from the NFC50/100(E). External Operator Interface Power (Non-supervised).

See *NFC-50/100(E) Product Manual P/N LS10001-001NF-E* for standby and alarm current requirements as well as battery calculations.

Cabinet Specifications

Backbox: 19.0" (48.26 cm) high x 16.65" (42.29 cm) wide x 5.2" (13.23) deep

Door: 19.26" (48.92cm) high x 16.821" (42.73cm) wide x 670" (1.707cm) deep

Trim Ring (TR-CE-B): 22.00" (55.88 cm.) high x 19.65" (49.91 cm.) wide

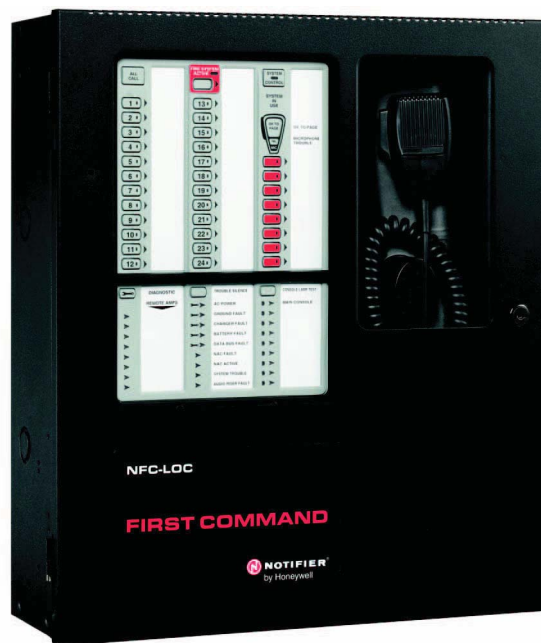

Shipping Specifications

Weight: 18.44 lbs (8.36 kg)

Agency Listings and Approvals

The listings and approvals below apply to the NFC-LOC Local Operator Console. In some cases, certain modules may not be listed by certain approval agencies or listing may be in process. Consult factory for latest listing status.

- UL Listed S635

Standards and Codes

The NFC-LOC complies with the following UL Standards, NFPA 72 Fire Alarm system requirements, International Building Codes, and California Building Codes.

- UL S635.
- UL 2572
- IBC 2012, IBC 2009, IBC 2006, IBC 2003, IBC 2000 (Seismic).
- CBC 2007 (Seismic)

Control and Indicators

PUSH BUTTON CONTROLS

- All Call
- MNS Control
- System Control
- Speaker Select 1-24
- Message Select Buttons 1-8
- Diagnostic Select
- Trouble Silence
- Console Lamp Test

LED STATUS INDICATORS (VISIBLE WITH DOOR CLOSED)

- Fire System Active (green)
- MNS Control (green)
- System Control (green)
- System in Use (green)
- Speaker Zone 1-24 Active (green)
- Speaker Zone 1-24 Fault (yellow)
- OK to Page (green)
- Microphone Trouble (yellow)
- Message 1-8 Active (red)
- Message 1-8 Fault (yellow)
- Remote Amplifier 1-8 Fault (yellow)
- LOC/RPU/RM 1-8 Fault (yellow)
- LOC/RPU/RM 1-8 Active (green)
- Main Console Fault (yellow)
- AC Power (green)
- Ground Fault (yellow)
- Charger Fault (yellow)
- Battery Fault (yellow)
- Data Bus Fault (yellow)
- NAC Fault (yellow)
- NAC Active (green)
- System Trouble (yellow)
- Audio Riser Fault (yellow)

LED STATUS INDICATORS (VISIBLE WITH DOOR AND DRESS PANEL OPEN)

- Speaker Volume Control Fault (yellow)
- Option Card Fault (yellow)
- Amplifier Over Current Fault (yellow)

Product Line Information (Ordering Information)

NFC-LOC: Local Operator Console (Complete user interface).

NFC-50/100: (Primary operating Console) 50 Watt, 25VRMS single speaker zone emergency voice evacuation system, Integral microphone, built in tone generator and 14 recordable messages. *Please refer to the data sheet DN-60772 for more information.*

NFC-50/100E: Export version (Primary operating Console) 50 Watt, 25VRMS single speaker zone emergency voice evacuation system, Integral microphone, built in tone generator and 14 recordable messages, 240 VAC, 50 Hz. *Please refer to the data sheet DN-60772 for more information.*

NFC-CE6: Speaker Circuit/Zone Expander Module.

NFC-BDA-25V: 25V, 50 watt audio amplifier module. Adding a second speaker circuit increases the total NFC-50/100 power output to 100 watts or can also be used as a backup amplifier.

NFC-BDA-70V: 70V, 50 watt audio amplifier module. Adding a second speaker circuit increases the total NFC-50/100 power output to 100 watts or can also be used as a backup amplifier.

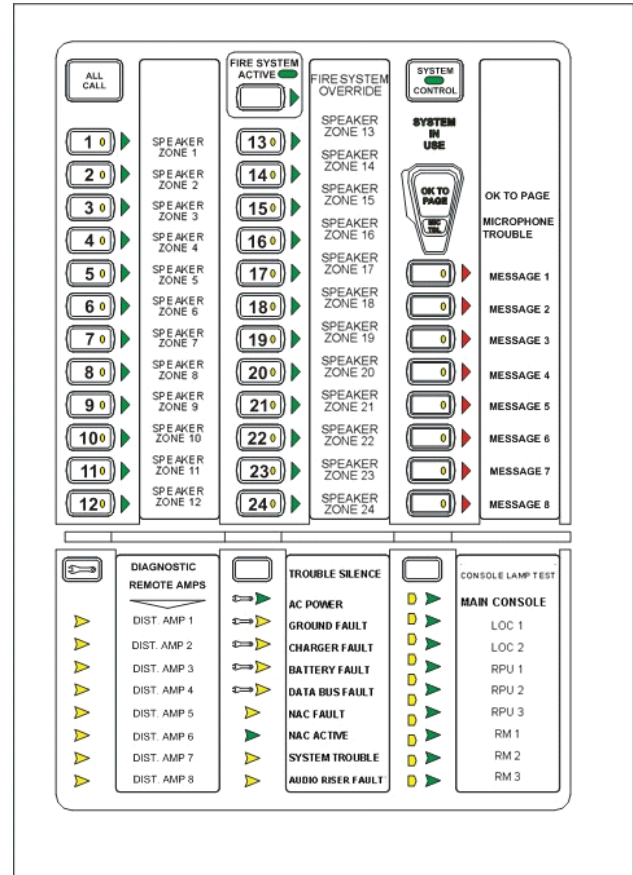

N-FPJ: Remote Phone Jack.

SEISKIT-COMMENC: Seismic kit for the NFC-LOC. *Please refer to document 53880 for requirements on mounting the NFC-LOC for seismic applications*

TR-CE-B: Optional Trim Ring. 17.624" high (44.77 cm) x 16.0" wide (40.64 cm).

CHG-75: 25 to 75 ampere-hours (AH) external battery charger.

CHG-120: 25-120 ampere-hours (AH) external battery charger.

ECC-MICROPHONE: Replacement microphone only.

BAT-1270: Battery, 12volt, 7.0AH (Two required).

BAT-12120: Battery, 12volt, 12.0AH (Two required).

BAT-12180: Battery, 12volt, 18.0AH (Two required).

ECC-THUMBLTCH: Optional Thumb Latch. (Non UL-listed).

Temperature and Humidity ranges

This system meets NFPA requirements for operation at 0-49° C/32-120° F and at a relative humidity 93% ± 2% RH (non-condensing) at 32°C ± 2°C (90°F ± 3°F). However, the useful life of the system's standby batteries and the electronic components may be adversely affected by extreme temperature ranges and humidity. Therefore, it is recommended that this

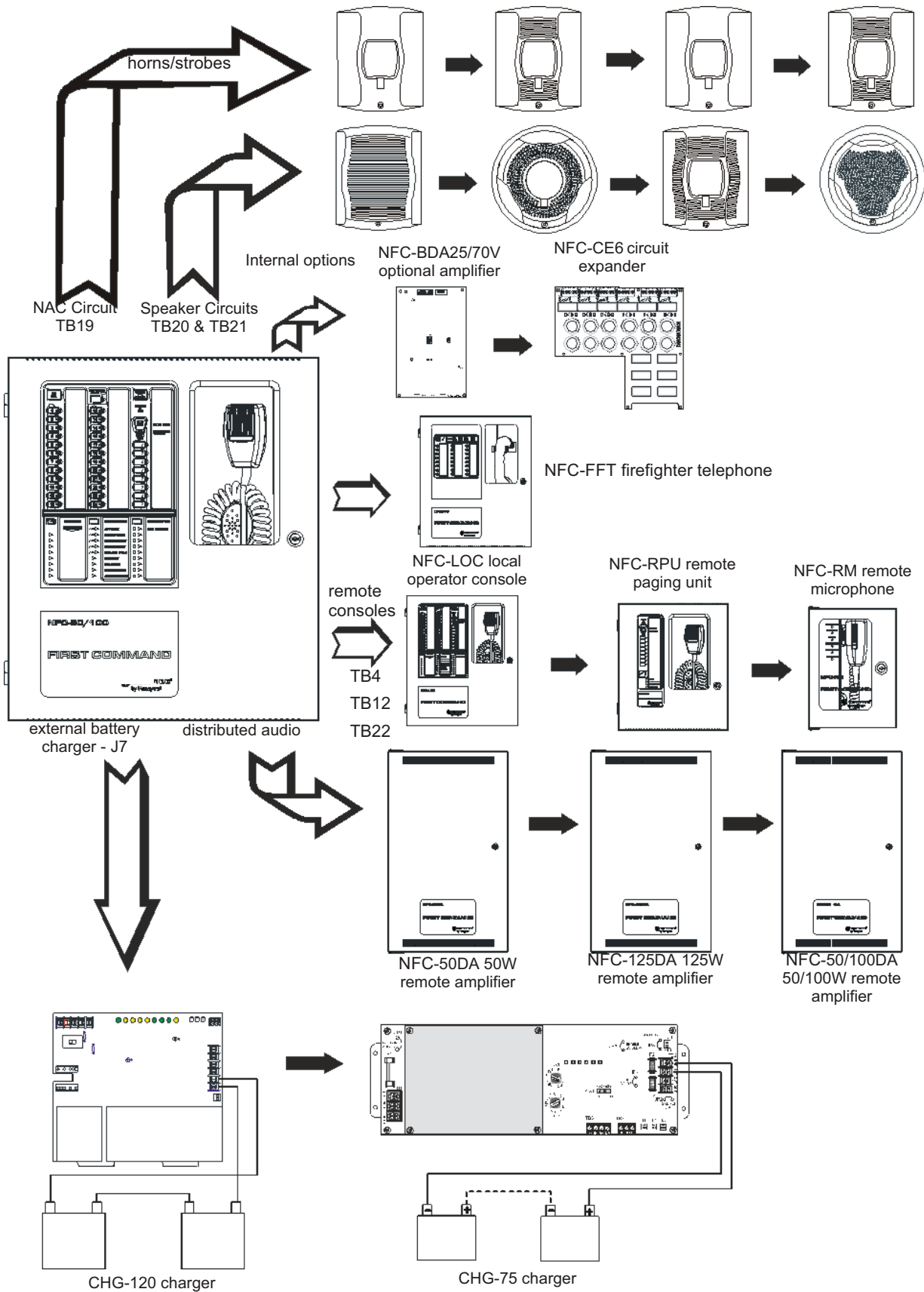

NFC-50/100(E) FirstCommand (Possible Configurations)

system and its peripherals be installed in an environment with a normal room temperature of 15-27° C/60-80° F.

Optional Accessories

TR-CE-B: Optional Trim Ring. 17.624" high (44.77 cm) x 16.0" wide (40.64 cm).

Wiring Requirements

See Product manual part number: LS10028-001NF-E for detailed wiring requirements.

FirstCommand® and Notifier® are registered trademarks of Honeywell International Inc.
©2015 by Honeywell International Inc. All rights reserved. Unauthorized use of this document is strictly prohibited.



This document is not intended to be used for installation purposes.
We try to keep our product information up-to-date and accurate.
We cannot cover all specific applications or anticipate all requirements.
All specifications are subject to change without notice.



Assembled in the USA

For more information, contact Notifier. Phone: (203) 484-7161, FAX: (203) 484-7118.
www.notifier.com